

Lord,
you have
been our
dwelling place
in all
generations.

Psalms 90:1

PLANTING JOY



Five Points
COMMUNITY CHURCH

We want to see our mission **sustained** and **expanded.**

That mission is to glorify God in all that we do through the Spirit by **finding our joy so supremely in Christ** that it overflows in a desire to draw our neighbors and the nations into worship of God with us now and forever.

For 75 years, we've been pursuing this mission by proclaiming the gospel, equipping Christians for the worship of God in all of life, cultivating authentic community, lovingly serving with Spirit-given gifts, and spreading the gospel through mission-focused living. All from the corner of Squirrel Rd & Walton Blvd in Auburn Hills. Lord willing, we will continue to pursue this mission here until Christ returns.





We are moving forward in bold faith...

with the construction of additional facilities and a capital campaign to fund it. But our goal is not merely to update and expand our physical footprint. No, these buildings serve to point us beyond the walls to our great God who is our dwelling place. Ultimately, **we yearn for people to know Him better** and for more people to know Him as their greatest delight.

*Blessing and glory and wisdom and thanksgiving and honor and power
and might be to our God forever and ever! Amen.*

Revelation 7:12



A building is not the goal, but it is a tool.

As Christ commissioned, our priority is people being baptized and discipled. Our desire is for these buildings to serve the people who gather in them.

Three buildings comprise our current facility, two of which were built well over fifty years ago. They are tools that have served well for decades, but they are showing their age. Not only were the current facilities not designed to serve the corporate worship and equipping of a community of our size, but we also live in different times—having a more efficiently and securely designed facility is needed to better serve our families and the guests who join us.

With this in mind, the design and construction of the building we are moving forward with will result in a much better suited tool for our mission. Moreover, **new construction better stewards our funds** that otherwise would go towards needed yet temporary renovations. Some of the new construction includes a dedicated children's wing. This will be more easily accessed by the guests who join us in worship as well as more secure to protect the youngest among us.

The new building will also serve our staff and ministry pursuits with new offices and meeting spaces. We will have a more hospitable venue and intentionally-designed spaces to cultivate unity in relationships. Finally, a dedicated sanctuary will more readily foster undistracted worship of the Lord Jesus Christ and allow us to pursue ministry opportunities presently hindered by meeting in a gymnasium.

Lord, you have been our dwelling place in all generations.

Psalm 90:1



We give ourselves to this vision in bold, confident faith

Our only hope in this life and the next is God Himself. Our only confidence is in Him. With rising building costs and an ever-changing, unpredictable culture desperately in need of the gospel, we move forward what God has already provided and trust Him to provide all that we need.

As such, we are pursuing a 24-month capital campaign starting in April 2017 and concluding in April 2019 with the goal of raising \$3,700,000. **Phase 1** of construction—which includes new offices, a children’s ministry wing, a large group meeting space, and site work—is on schedule to begin in May 2017 and be completed by the end of the year. Our goal is to begin construction on **Phase 2**—a dedicated sanctuary and central foyer—in May 2018.

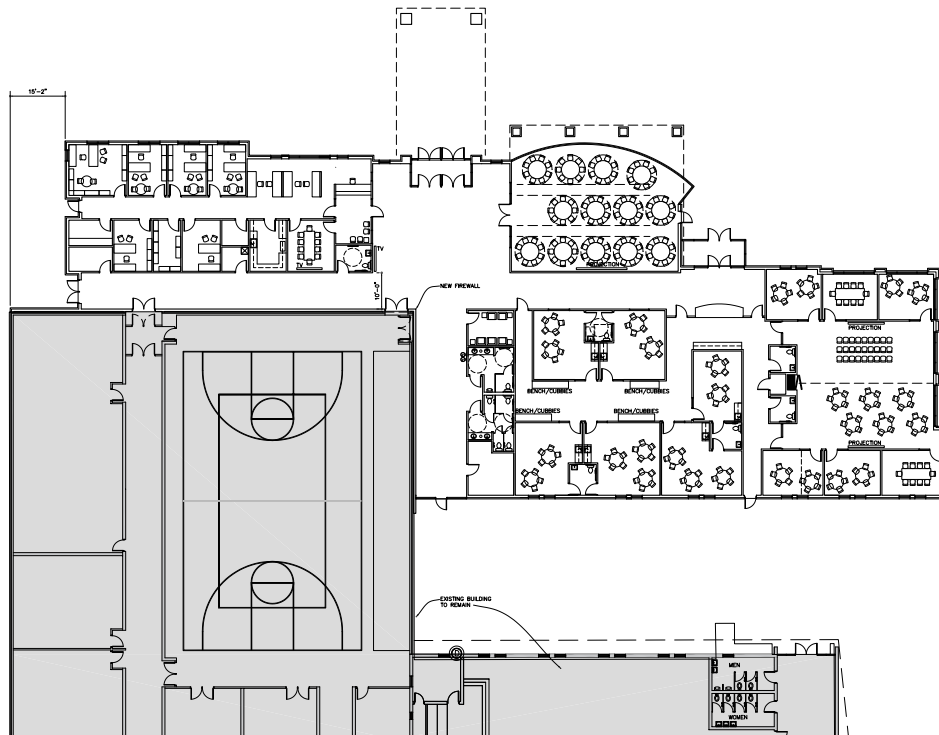



As one who shares our vision of God and a love for His glory to be communicated throughout the world, we are asking you to join us in this faith-filled venture.

Pray that God would accomplish our mission through our engagement in His redemptive purposes.

Pray that He would provide all that we need for this building project while not being distracted from the grander purposes of gospel ministry.

Pray that He would be shown to be our greatest treasure as we selflessly and joyfully give to the advance of the gospel from this corner.

GIVE

We invite you to give. We desire your sacrificial participation at any amount. We are seeking to have as many people as possible join us in **rejoicing in what we trust the Lord will do** through this campaign.

He is already at work as we anticipate receiving approximately \$400,000 in matching funds for this campaign. Our hope—and what we are asking the Lord—is for the full amount to be pledged by May 31, 2017.

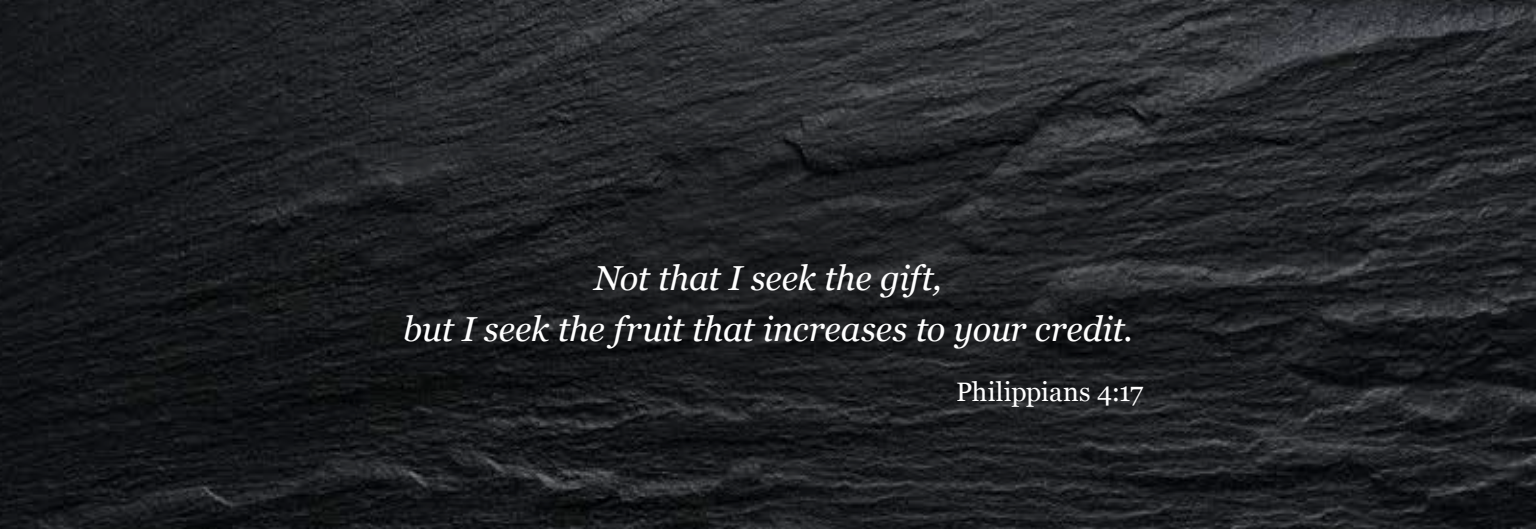

*Not that I seek the gift,
but I seek the fruit that increases to your credit.*

Philippians 4:17

As you prayerfully consider the amount you would pledge towards this campaign, the enclosed card is designed for one half to be returned and the other half to serve as a reminder for you of the commitment you have made. May it also serve as a reminder to continue to pray for God's glory to be seen and treasured by us, our neighbors, and the nations.

Phase 1 construction begins soon and is close to being fully funded. To meet our goal for **Phase 2**, we ask you to pray that God will enable you to fulfill the pledge you make to Him towards this vision so that in all things He receives the glory and we get the joy of seeing this vision accomplished by His grace. So, we invite you to begin giving towards this project now.

We are grateful for your partnership in pursuing this mission with us for the glory and praise of God.

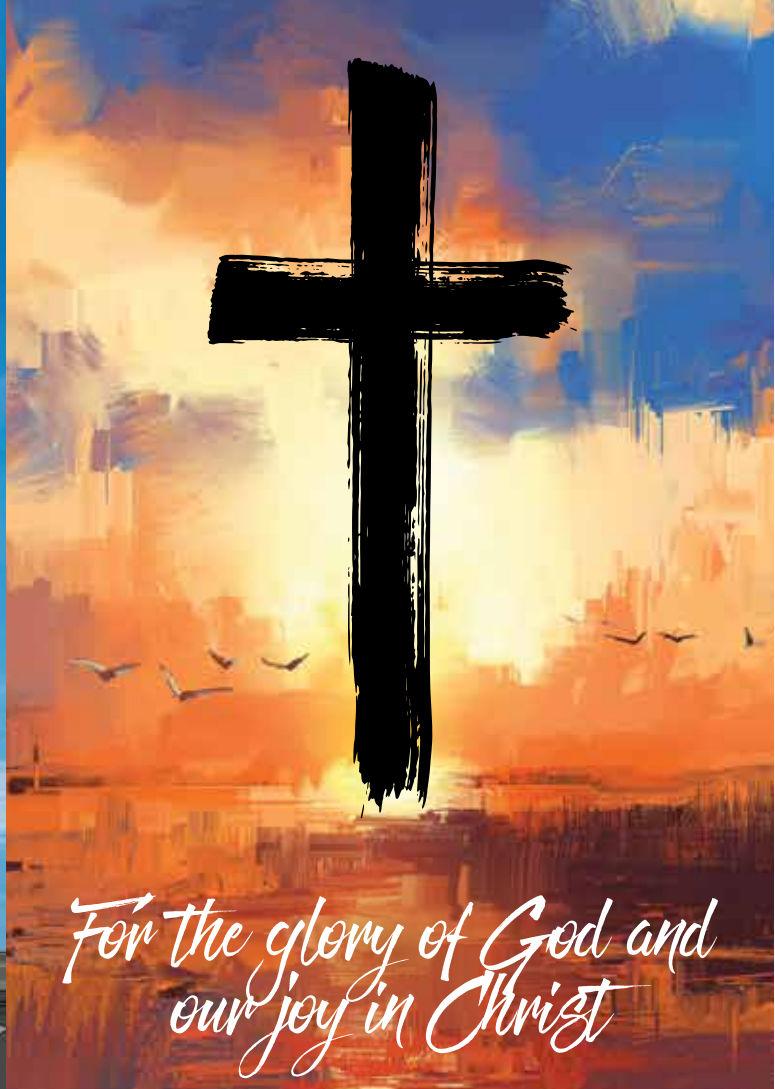

PLANTING JOY



Five Points
COMMUNITY CHURCH



Five Points
COMMUNITY CHURCH

Planting Joy

Capital Campaign 2017-19

As the Lord enables, I/we pledge the following as a matching grant for the Planting Joy Building Fund at Five Points Community Church:

TOTAL AMOUNT

I anticipate donating on the following basis:

\$ _____ by year end 2017

\$ _____ by year end 2018

\$ _____ by year end 2019

☐ Monthly

☐ Quarterly

☐ One time

NAME

ADDRESS

CITY, STATE, ZIP

Please return this pledge card by May 31, 2017.

**More options on back*

Five Points Community Church
Attn: Financial Secretary
3411 E Walton Blvd
Auburn Hills, MI 48326

Submit a pledge at
5pointsc.org/building



Five Points
COMMUNITY CHURCH



PLANTING JOY



Five Points
COMMUNITY CHURCH